

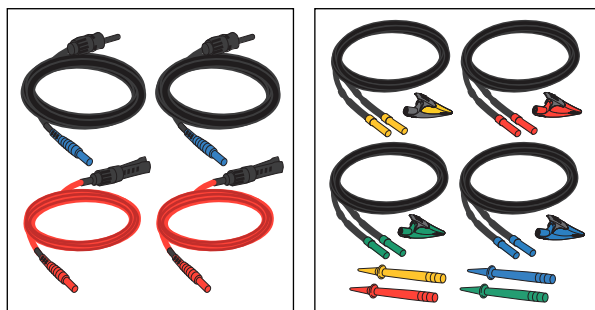

FLUKE®

SMFT-1000 Multifunction PV Analyzer

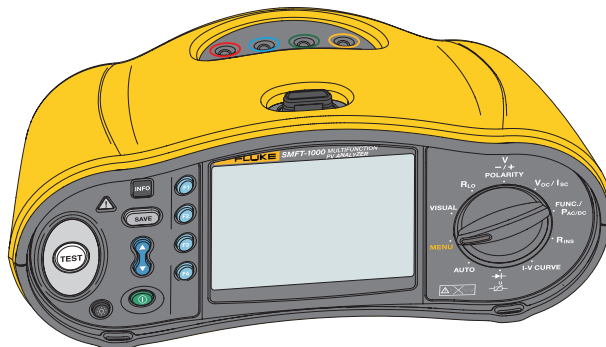

PN 5292395 9/2022
©2022 Fluke Corporation. All Rights Reserved.

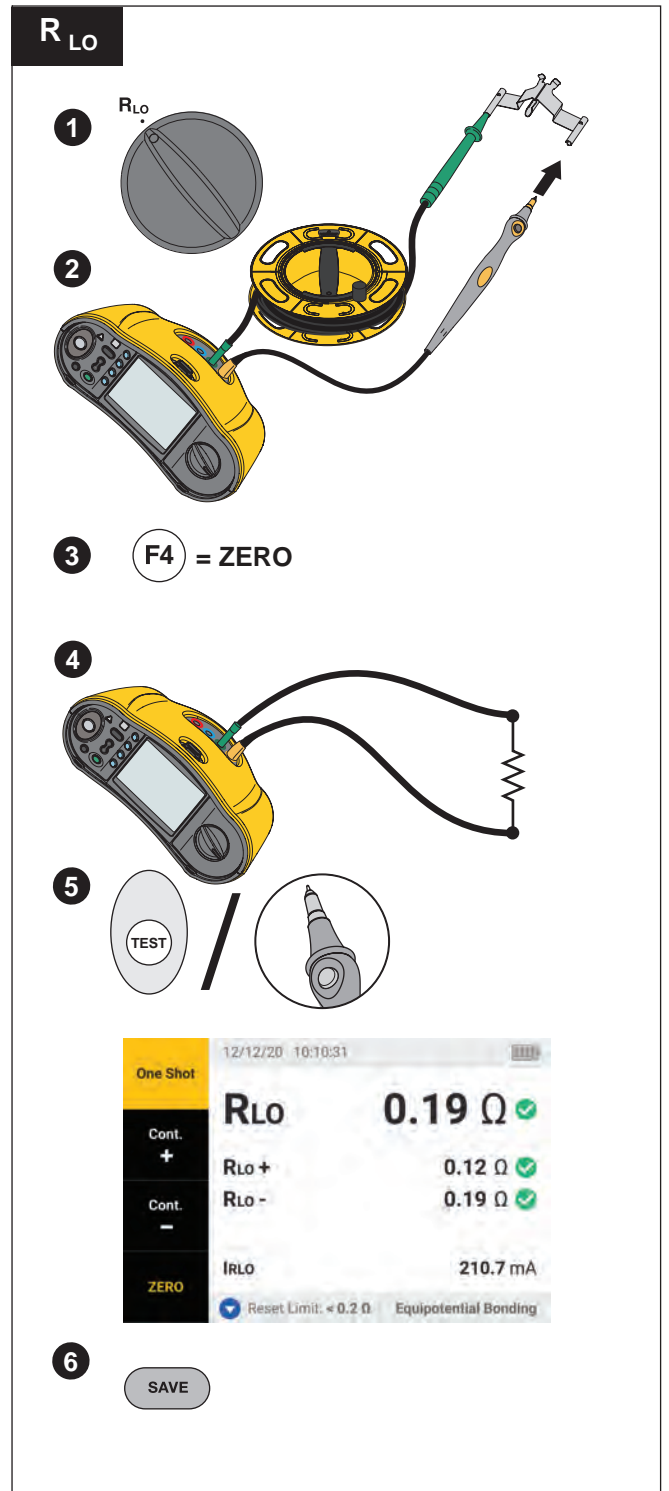
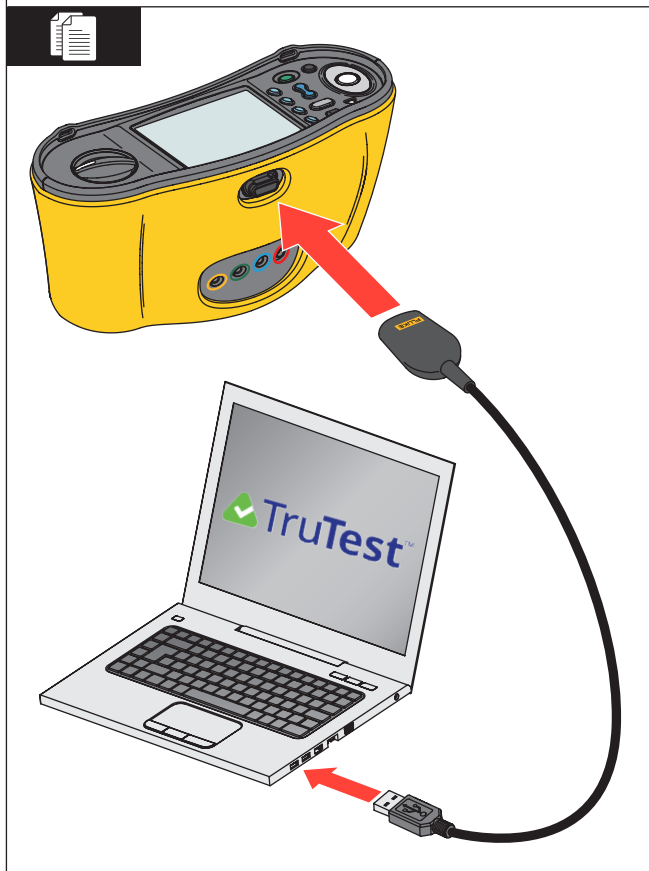
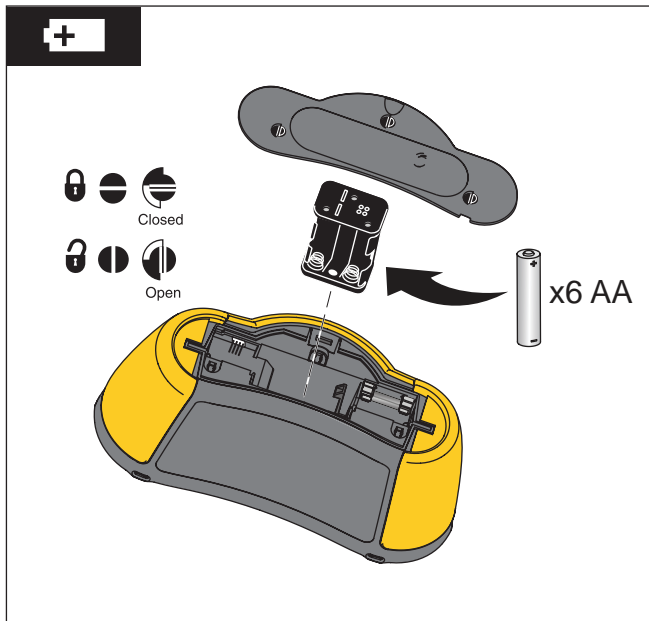

V -/+ POLARITY

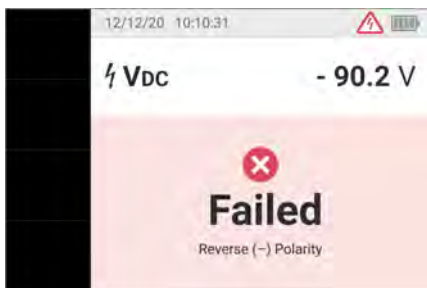
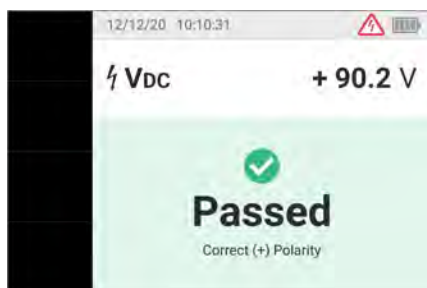
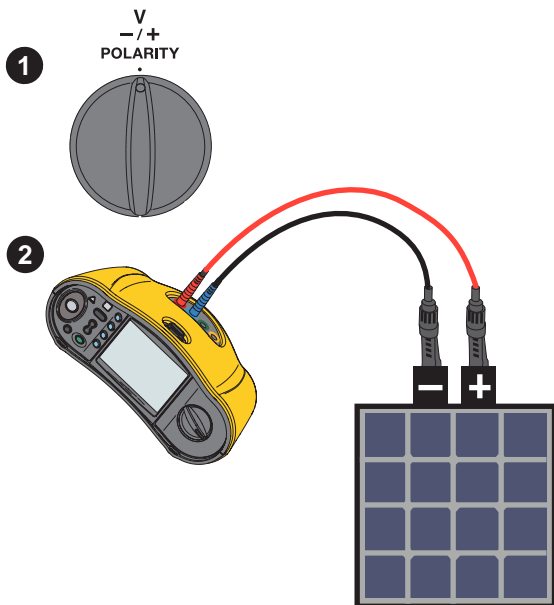

V_{OC}/I_{SC}

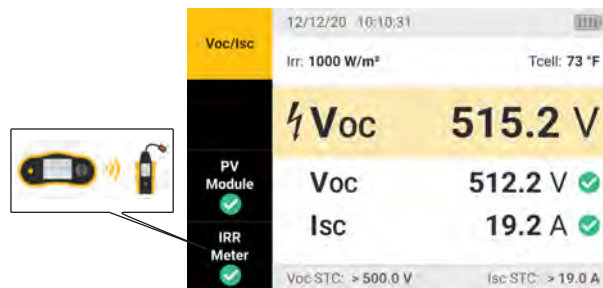
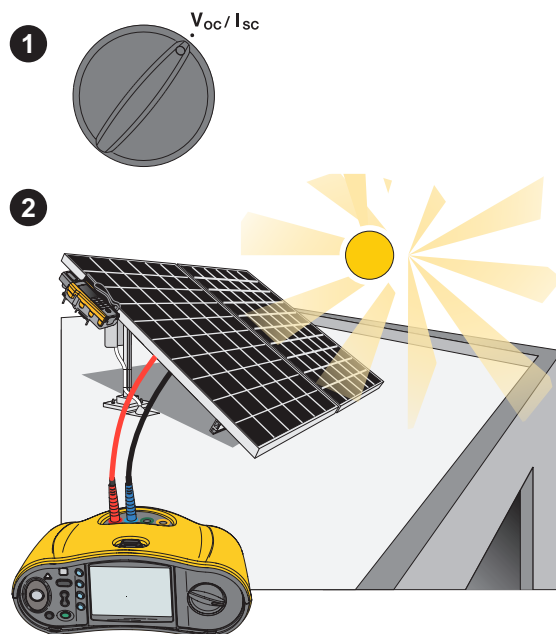

FUNC./P_{AC/DC}

1

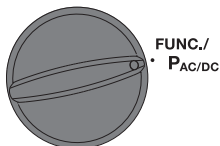

2

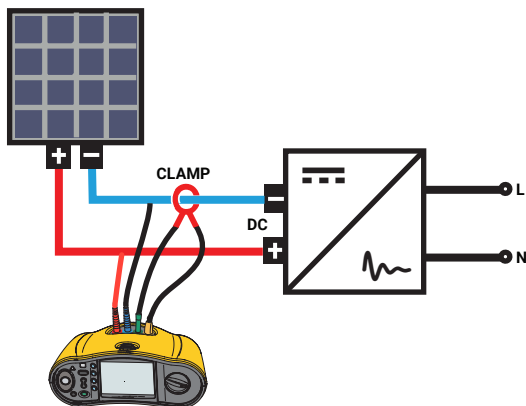

3

TEST

Power	12/12/20 10:10:31	
	DC	AC
Voltage	993.9 Vdc	--- Vac
Current	20.1 Adc	--- Aac
P	19.97 kW	--- kVA
HOLD		
Functional	Measure AC side Press F3 to hold AC measurements.	
	Reset	

4

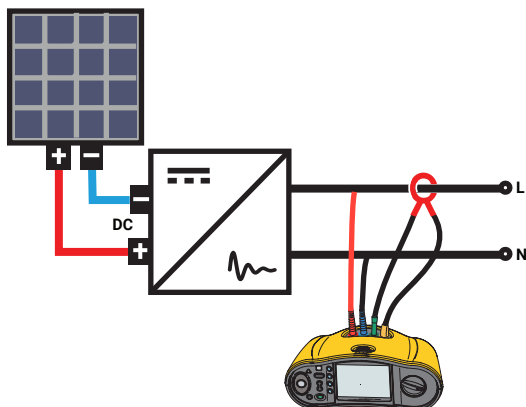

R_{INS}

1

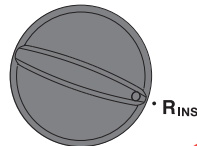

2

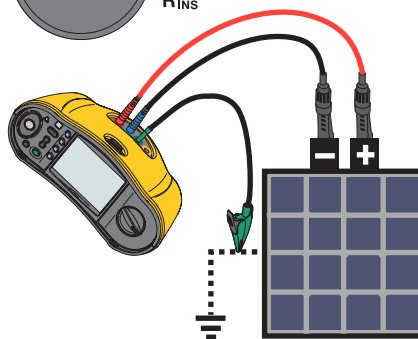

3

Rins I	12/12/20 10:10:31	
Rins II	RINS (II) 1.23 MΩ	
Rins Cont.		
Wet Insulation	VINS 512 V	
	Reset Vn: 500 V	Limit: > 1.0 MΩ

SAVE

5

TEST

Power	12/12/20 10:10:31	
	DC	AC
Voltage	993.9 Vdc	989.1 Vac
Current	20.1 Adc	19.2 Aac
P	19.97 kW	18.89 kVA
HOLD		
Functional	Measure AC side Press F3 to hold AC measurements.	
	Reset	

6

F3

Efficiency Factor:
94.5 %

7

SAVE

I-V

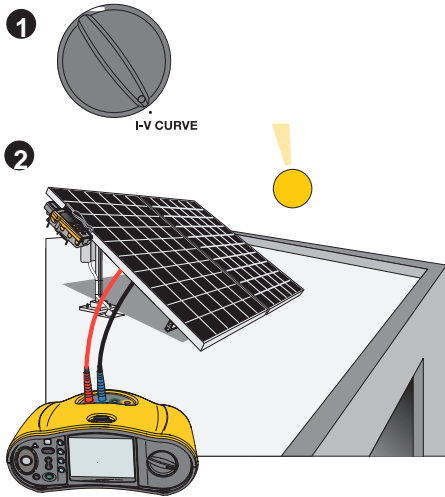
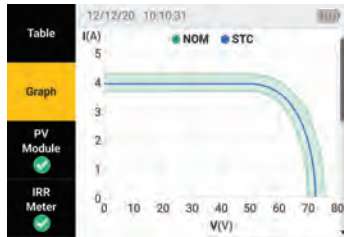

Table 12/12/20 10:10:31

Ir: 1000 W/m² Tcell: 73 °F

	NOM	STC
Voc	44.4 V	40.2 V
Isc	5.4 A	5.1 A
Vmpp	50.2 V	50.1 V
Impp	6.4 A	6.1 A
Pmpp	175 W	170 W
FF	95 %	92 %

Pass Criteria: 5%



SAVE

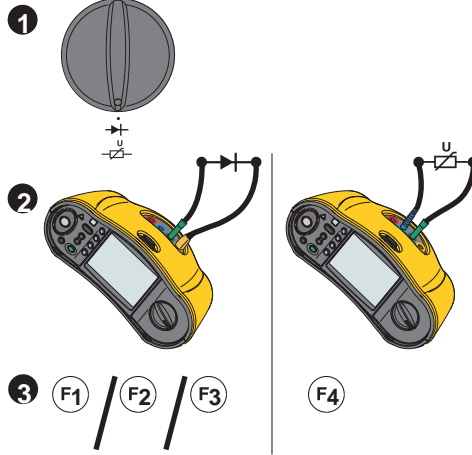

TES

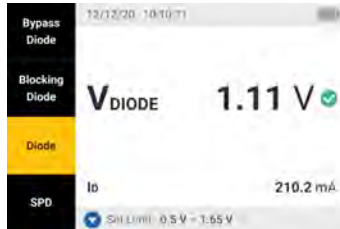

SAVE

IRR2-

